



April 5<sup>th</sup>, 2019

Delhaize America Shared Services Group, LLC  
Mr. Charles McLendon  
Specialist II – Format and Planning  
2110 Executive Drive; Salisbury, NC 28145

Re: Asbestos Inspection Report  
Food Lion #1653  
1565 Hyde Park Rd  
Essex, MD 21221

Dear Mr. McLendon:

Winchester Environmental Consultants Inc. (WECI) is pleased to submit this Asbestos Survey for the above referenced site. These services have been performed in accordance with our proposal dated February 21<sup>st</sup>, 2019.

#### **Purpose of Study**

To walkthrough store 1653 and obtain representative samples of suspect asbestos containing materials (ACM) for laboratory analysis from Store 1653 slated for renovations.

#### **Scope of Services**

Our scope of services for this phase of the project included the following:

- Walkthrough of stores to evaluate building material to identify suspected asbestos containing materials (ACM).
- The representative sampling of select suspect asbestos containing materials (roofing, flooring and miscellaneous material) as directed by you conducted by a current Maryland licensed and EPA accredited asbestos inspector. (membrane style roofs were not cut or inspected below the membrane were applicable due to warranty considerations).
- Submission of samples to NVLAP certified AmeriSci laboratory located in Richmond, Virginia, for bulk asbestos analyses utilizing polarized light microscopy (PLM).
- Preparation of this findings report presenting identified asbestos containing materials, bulk asbestos analysis, pertinent QA/QC information and any conclusions and recommendations.

### Asbestos Inspection

WECI asbestos inspector Andrew Cook performed a site visit on March 26<sup>th</sup>, 2019 to identify any areas of suspect ACM and if necessary collect samples of suspected asbestos containing materials. At the request of Food Lion, WECI inspected the interior and exterior of the stores including the sales floor and restroom areas but did not conduct invasive sampling on existing membrane roofs. In cases where multiple layers of flooring existed in the stores, “best guess” estimations were provided as to the extent of the sub-layers.

Materials identified and sampled in the study area of Store 1653 included drywall, drop ceiling tile, floor tile, roofing, and mastic (where applicable). The general construction of the store includes steel frame, rubberized membrane roof, concrete block, drywall and concrete floors with floor tile. Materials collected during this study and the associated laboratory analyses are detailed in the attached sample log.

### Laboratory Analysis

WECI submitted the 26 samples collected within the study area of Store 1653 to AmeriSci laboratory located in Richmond, Virginia for PLM analysis. Including laboratory-separated samples, 30 samples were analyzed during this study. **None of the samples were reported to contain asbestos.** Asbestos containing materials are defined as those materials containing greater than 1% asbestos by weight. Certificates of Analysis and the Chain of Custody are presented.

### Conclusions and Recommendations

Based on WECI’s walkthroughs of Store 1653 on March 26<sup>th</sup>, 2019 **no asbestos containing material was identified in the building.** Predicated on these results, the building materials outline in this survey can be disturbed or demolished without further consideration for asbestos.

WECI, Inc. appreciates the opportunity to provide asbestos inspection services for this project. If you should have any questions, please do not hesitate to contact our office at 540-877-9420.

Sincerely,  
WECI Inc.

A handwritten signature in black ink, appearing to read "Andrew Cook", with a stylized flourish at the end.

Andrew Cook  
19004771

### **Asbestos Limitations for Inspection, Bulk Sampling and Analysis Reports**

This report has been prepared for the exclusive use of Food Lion, Inc. and/or their agents. It has been prepared in accordance with generally accepted environmental practices in conjunction with Food Lion's instructions regarding the types of materials to be sampled. No other warranty, expressed or implied, is made. Our conclusions and recommendations are based, in part, upon information provided to us by others and our site observations. We have not verified the completeness or accuracy of the information provided by others.

Our observations and recommendations are based upon conditions readily visible during the site at the time of our site visit, and upon current industry standards. During WECI inspection, all accessible areas were visually surveyed for the presence of suspect asbestos-containing materials. Inaccessible areas, such as behind solid ceilings or behind solid walls were not surveyed. Areas inspected for suspect asbestos-containing materials were limited to those designated by the scope of services. All samples were collected by individuals who have completed EPA approved asbestos inspector/management planner courses. Samples were collected and submitted for analysis via polarized light microscopy at AmeriSci laboratory, an accredited laboratory.

WECI, by the virtue of providing the services described in this report, does not assume the responsibility of the person(s) in charge of the site, or otherwise undertake responsibility for reporting to any local, State, or Federal public agencies any conditions at the site that may present a potential danger to public health, safety, or the environment. It is the Client's responsibility to notify the appropriate local, state, or federal public agencies as required by law, or otherwise to disclose, in a timely manner, any information that may be necessary to prevent any danger to public health, safety, or the environment.

Under this scope of services, WECI assumes no responsibility regarding response actions (O&M plan, encapsulation, abatement, removal, etc.) initiated as a result of these findings. Response actions are the sole responsibility of the Client and should be conducted in accordance with local, State, and/or Federal requirements, and should be performed by appropriate licensed-asbestos personnel, as warranted.

**ATTACHMENT A**  
**CERTIFICATES OF ANALYSES & CHAIN OF CUSTODY**

## Food Lion 1653 Asbestos Sample Map

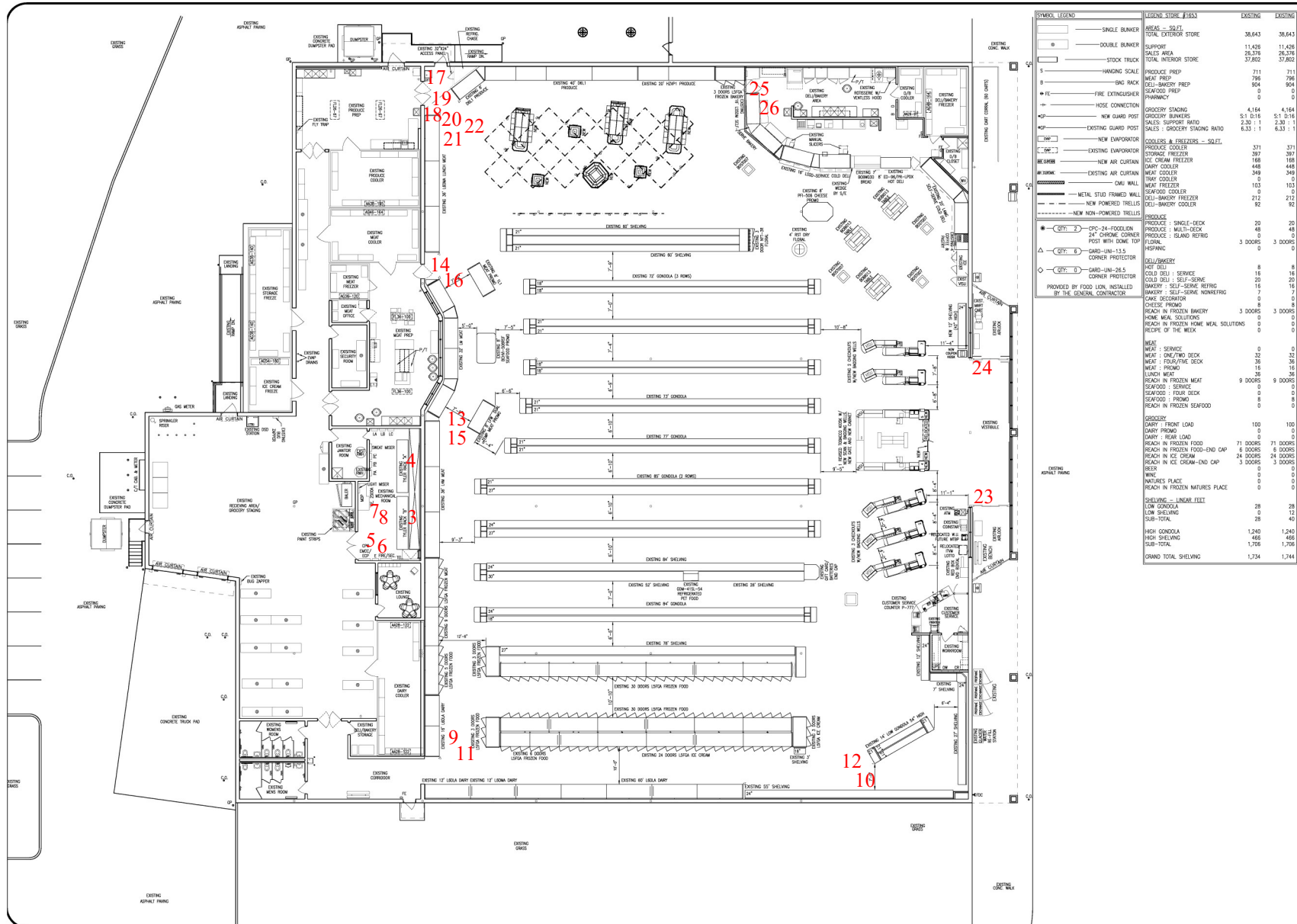

**FOOD LION**

GRAVE #:	KLC
CHECKED BY:	

FOOD LION STORE NO. 1653  
1565 HYDE PARK STATION ESSEX, MARYLAND 21223

REV.	DAT.
.	.

**DISCLAIMER**  
THIS IS NOT A COMFORTER.  
DRAWING HAS BEEN PROVIDED  
FOR CLARITY. A COMFORTER  
OR CLARITY AND SHOULD BE A  
COMFORTER WHO HAS BEEN  
LOCAL, DISPERSED, AND ALL  
DISPERSED FOR THE

PROJECT  
1653FL

FILE #  
1653A1.

SHEET  
A1.

SHEET NO.  
1 OF 1

**TABLE I**  
**ASBESTOS SAMPLE RESULTS**  
**Store # 1653**  
**Essex, MD**

Sample	Sample Description	Sample Location	Condition	Friable	Size	Asbestos %
MM-1	White Caulk	Roof	Good	N/A	N/A	None Detected
MM-2	Black Caulk	Roof	Good	N/A	N/A	None Detected
MM-3	Drywall	Throughout	Good	N/A	N/A	None Detected
MM-4	Drywall	Throughout	Good	N/A	N/A	None Detected
MM-4	Joint Compound	Throughout	Good	N/A	N/A	None Detected
MM-5	Ceiling Tile	Throughout	Good	N/A	N/A	None Detected
MM-6	Ceiling Tile	Throughout	Good	N/A	N/A	None Detected
MM-7	Black Base Cove	Throughout	Good	N/A	N/A	None Detected
MM-8	Black Base Cove	Throughout	Good	N/A	N/A	None Detected
MM-9	White 12x12 Floor Tile	Throughout	Good	N/A	N/A	None Detected
MM-10	White 12x12 Floor Tile	Throughout	Good	N/A	N/A	None Detected
MM-11	Tan 12x12 Floor Tile	Throughout	Good	N/A	N/A	None Detected
MM-12	Tan 12x12 Floor Tile	Throughout	Good	N/A	N/A	None Detected
MM-13	Orange 12x12 Floor Tile	Meat Area/In front of Deli	Good	N/A	N/A	None Detected
MM-14	Orange 12x12 Floor Tile	Meat Area/In front of Deli	Good	N/A	N/A	None Detected
MM-15	Maroon 12x12 Floor Tile	Meat Area/In front of Deli	Good	N/A	N/A	None Detected
MM-16	Maroon 12x12 Floor Tile	Meat Area/In front of Deli	Good	N/A	N/A	None Detected
MM-17	Dark Gray 12x12 Floor Tile	Produce	Good	N/A	N/A	None Detected
MM-18	Dark Gray 12x12 Floor Tile	Produce	Good	N/A	N/A	None Detected
MM-18	Dark Gray 12x12 Floor Tile Mastic	Produce	Good	N/A	N/A	None Detected
MM-19	Dark Tan 12x12 Floor Tile	Produce	Good	N/A	N/A	None Detected
MM-20	Dark Tan 12x12 Floor Tile	Produce	Good	N/A	N/A	None Detected
MM-21	Black Border Tile	Meat Area/Produce	Good	N/A	N/A	None Detected
MM-22	Black Border Tile	Meat Area/Produce	Good	N/A	N/A	None Detected
MM-23	Cream 12x12 Floor Tile	Front of Store	Good	N/A	N/A	None Detected
MM-24	Cream 12x12 Floor Tile	Front of Store	Good	N/A	N/A	None Detected
MM-25	Ceiling Tile	Deli	Good	N/A	N/A	None Detected

MM-26	Ceiling Tile	Deli	Good	N/A	N/A	None Detected
-------	--------------	------	------	-----	-----	---------------



Please Reply To:

**AmeriSci Richmond**

13635 GENITO ROAD  
MIDLOTHIAN, VIRGINIA 23112  
TEL: (804) 763-1200 • FAX: (804) 763-1800

**FACSIMILE TELECOPY TRANSMISSION**

**To:** Andrew Cook  
WECI Inc

**Fax #:**

**Email:** acook@thinkweci.com

**From:** Jean L. Mayes ✓  
**AmeriSci Job #:** 119032154  
**Subject:** PLM 5 day Results  
**Client Project:** Food Lion #1653; 1565 Hyde Park  
Station, Essex, MD

**Date:** Tuesday, April 2, 2019

**Time:** 11:49:10

**Comments:**

**Number of Pages:** 9  
(including cover sheet)

CONFIDENTIALITY NOTICE: Unless otherwise indicated, the information contained in this communication is confidential information intended for use of the individual named above. If the reader of this communication is not the intended recipient, you are hereby notified that any dissemination, distribution or copying of this communication is prohibited. If you have received this communication in error, please immediately notify the sender by telephone and return the original message to the above address via the US Postal Service at our expense. Samples are disposed of in 60 days or unless otherwise instructed by the protocol or special instructions in writing. Thank you.

**Certified Analysis   Service 24 Hours A Day • 7 Days A Week   Competitive Prices**  
visit our web site - [www.ameriscil.com](http://www.ameriscil.com)

**Boston • Los Angeles • New York • Richmond**



**AmeriSci Richmond**

13635 GENITO ROAD  
MIDLOTHIAN, VIRGINIA 23112  
TEL: (804) 763-1200 • FAX: (804) 763-1800

## PLM Bulk Asbestos Report

WECI Inc  
Attn: Andrew Cook  
119-1 Sulky Drive

Winchester, VA 22602

**Date Received** 03/28/19 **AmeriSci Job #** 119032154  
**Date Examined** 04/02/19 **P.O. #**  
**Page** 1 **of** 6  
**RE:** Food Lion #1653; 1565 Hyde Park Station, Essex, MD

Client No. / HGA	Lab No.	Asbestos Present	Total % Asbestos
MM-1 Location: Roof; White Caulk  Analyst Description: Gray, Heterogeneous, Non-Fibrous, Bulk Material Asbestos Types: Other Material: Non-fibrous 100 %	119032154-01	No	NAD (by CVES) by Jean L. Mayes on 04/02/19
MM-2 Location: Roof; Black Caulk  Analyst Description: Black, Heterogeneous, Non-Fibrous, Bulk Material Asbestos Types: Other Material: Non-fibrous 100 %	119032154-02	No	NAD (by CVES) by Jean L. Mayes on 04/02/19
MM-3 Location: Throughout; Drywall/Joint  Analyst Description: White, Heterogeneous, Non-Fibrous, Drywall Asbestos Types: Other Material: Cellulose 2 %, Non-fibrous 98 %	119032154-03	No	NAD (by CVES) by Jean L. Mayes on 04/02/19
MM-4 Location: Throughout; Drywall/Joint  Analyst Description: White/Brown, Heterogeneous, Non-Fibrous, Drywall Asbestos Types: Other Material: Cellulose 10 %, Non-fibrous 90 %	119032154-04.1	No	NAD (by CVES) by Jean L. Mayes on 04/02/19
MM-4 Location: Throughout; Drywall/Joint  Analyst Description: White, Heterogeneous, Non-Fibrous, Joint Compound Asbestos Types: Other Material: Non-fibrous 100 %	119032154-04.2	No	NAD (by CVES) by Jean L. Mayes on 04/02/19

Client Name: WECI Inc

**PLM Bulk Asbestos Report**

Food Lion #1653; 1565 Hyde Park Station, Essex, MD

Client No. / HGA	Lab No.	Asbestos Present	Total % Asbestos
MM-5 Location: Throughout; Ceiling Tile  Analyst Description: Tan, Heterogeneous, Fibrous, Bulk Material Asbestos Types: Other Material: Cellulose 40 %, Fibrous glass 30 %, Non-fibrous 30 %	119032154-05	No	NAD (by CVES) by Jean L. Mayes on 04/02/19
MM-6 Location: Throughout; Ceiling Tile  Analyst Description: Tan, Heterogeneous, Fibrous, Bulk Material Asbestos Types: Other Material: Cellulose 40 %, Fibrous glass 30 %, Non-fibrous 30 %	119032154-06	No	NAD (by CVES) by Jean L. Mayes on 04/02/19
MM-7 Location: Throughout; Black Base Cove  Analyst Description: Black, Heterogeneous, Non-Fibrous, Bulk Material Asbestos Types: Other Material: Non-fibrous 100 %	119032154-07	No	NAD (by CVES) by Jean L. Mayes on 04/02/19
MM-8 Location: Throughout; Black Base Cove  Analyst Description: Black, Heterogeneous, Non-Fibrous, Bulk Material Asbestos Types: Other Material: Non-fibrous 100 %	119032154-08	No	NAD (by CVES) by Jean L. Mayes on 04/02/19
MM-9 Location: Throughout; White 12x12 Floor Tile/Mastic  Analyst Description: White, Heterogeneous, Non-Fibrous, Floor Tile Asbestos Types: Other Material: Non-fibrous 100 %	119032154-09L1	No	NAD (by CVES) by Jean L. Mayes on 04/02/19
MM-9 Location: Throughout; White 12x12 Floor Tile/Mastic  Analyst Description: Mastic Asbestos Types: Other Material: Comment: Quantity Insufficient For Analysis	119032154-09L2		NA

See Reporting notes on last page

Client Name: WECI Inc

# PLM Bulk Asbestos Report

Food Lion #1653; 1565 Hyde Park Station, Essex, MD

Client No. / HGA	Lab No.	Asbestos Present	Total % Asbestos
MM-10	119032154-10L1	No	NAD
Location: Throughout; White 12x12 Floor Tile/Mastic			(by CVES) by Jean L. Mayes on 04/02/19
Analyst Description: White, Heterogeneous, Non-Fibrous, Floor Tile			
Asbestos Types:			
Other Material: Non-fibrous 100 %			
MM-10	119032154-10L2		NA
Location: Throughout; White 12x12 Floor Tile/Mastic			
Analyst Description: Mastic			
Asbestos Types:			
Other Material:			
Comment: Quantity Insufficient For Analysis			
MM-11	119032154-11	No	NAD
Location: Throughout; Tan 12x12 Floor Tile			(by CVES) by Jean L. Mayes on 04/02/19
Analyst Description: Tan, Heterogeneous, Non-Fibrous, Bulk Material			
Asbestos Types:			
Other Material: Non-fibrous 100 %			
MM-12	119032154-12	No	NAD
Location: Throughout; Tan 12x12 Floor Tile			(by CVES) by Jean L. Mayes on 04/02/19
Analyst Description: Tan, Heterogeneous, Non-Fibrous, Bulk Material			
Asbestos Types:			
Other Material: Non-fibrous 100 %			
MM-13	119032154-13	No	NAD
Location: Meat Area & In Front Of Deli; Orange 12x12 Floor Tile			(by CVES) by Jean L. Mayes on 04/02/19
Analyst Description: Orange, Heterogeneous, Non-Fibrous, Bulk Material			
Asbestos Types:			
Other Material: Non-fibrous 100 %			

**PLM Bulk Asbestos Report**

Food Lion #1653; 1565 Hyde Park Station, Essex, MD

Client No. / HGA	Lab No.	Asbestos Present	Total % Asbestos
MM-14	119032154-14	No	NAD
Location: Meat Area & In Front Of Deli; Orange 12x12 Floor Tile			(by CVES) by Jean L. Mayes on 04/02/19
Analyst Description: Orange, Heterogeneous, Non-Fibrous, Bulk Material			
Asbestos Types:			
Other Material: Non-fibrous 100 %			
MM-15	119032154-15	No	NAD
Location: Meat Area & In Front Of Deli; Maroon 12x12 Floor Tile			(by CVES) by Jean L. Mayes on 04/02/19
Analyst Description: Brown, Heterogeneous, Non-Fibrous, Bulk Material			
Asbestos Types:			
Other Material: Non-fibrous 100 %			
MM-16	119032154-16	No	NAD
Location: Meat Area & In Front Of Deli; Maroon 12x12 Floor Tile			(by CVES) by Jean L. Mayes on 04/02/19
Analyst Description: Brown, Heterogeneous, Non-Fibrous, Bulk Material			
Asbestos Types:			
Other Material: Non-fibrous 100 %			
MM-17	119032154-17	No	NAD
Location: Produce Area; Dark Gray 12x12 Floor Tile			(by CVES) by Jean L. Mayes on 04/02/19
Analyst Description: Gray, Heterogeneous, Non-Fibrous, Bulk Material			
Asbestos Types:			
Other Material: Non-fibrous 100 %			
MM-18	119032154-18L1	No	NAD
Location: Produce Area; Dark Gray 12x12 Floor Tile			(by CVES) by Jean L. Mayes on 04/02/19
Analyst Description: Gray, Heterogeneous, Non-Fibrous, Floor Tile			
Asbestos Types:			
Other Material: Non-fibrous 100 %			
MM-18	119032154-18L2	No	NAD
Location: Produce Area; Dark Gray 12x12 Floor Tile			(by CVES) by Jean L. Mayes on 04/02/19
Analyst Description: Yellow, Heterogeneous, Non-Fibrous, Mastic			
Asbestos Types:			
Other Material: Cellulose 2 %, Non-fibrous 98 %			

# PLM Bulk Asbestos Report

Food Lion #1653; 1565 Hyde Park Station, Essex, MD

Client No. / HGA	Lab No.	Asbestos Present	Total % Asbestos
MM-19 <b>Location:</b> Produce Area; Dark Tan 12x12 Floor Tile  <b>Analyst Description:</b> Brown, Heterogeneous, Non-Fibrous, Bulk Material <b>Asbestos Types:</b> <b>Other Material:</b> Non-fibrous 100 %	119032154-19	No	NAD (by CVES) by Jean L. Mayes on 04/02/19
MM-20 <b>Location:</b> Produce Area; Dark Tan 12x12 Floor Tile  <b>Analyst Description:</b> Brown, Heterogeneous, Non-Fibrous, Bulk Material <b>Asbestos Types:</b> <b>Other Material:</b> Non-fibrous 100 %	119032154-20	No	NAD (by CVES) by Jean L. Mayes on 04/02/19
MM-21 <b>Location:</b> Meat & Produce; Black Border Tile  <b>Analyst Description:</b> Black, Heterogeneous, Non-Fibrous, Bulk Material <b>Asbestos Types:</b> <b>Other Material:</b> Non-fibrous 100 %	119032154-21	No	NAD (by CVES) by Jean L. Mayes on 04/02/19
MM-22 <b>Location:</b> Meat & Produce; Black Border Tile  <b>Analyst Description:</b> Black, Heterogeneous, Non-Fibrous, Bulk Material <b>Asbestos Types:</b> <b>Other Material:</b> Non-fibrous 100 %	119032154-22	No	NAD (by CVES) by Jean L. Mayes on 04/02/19
MM-23 <b>Location:</b> Front Of Store; Cream 12x12 Floor Tile  <b>Analyst Description:</b> Cream, Heterogeneous, Non-Fibrous, Bulk Material <b>Asbestos Types:</b> <b>Other Material:</b> Non-fibrous 100 %	119032154-23	No	NAD (by CVES) by Jean L. Mayes on 04/02/19
MM-24 <b>Location:</b> Front Of Store; Cream 12x12 Floor Tile  <b>Analyst Description:</b> Cream, Heterogeneous, Non-Fibrous, Bulk Material <b>Asbestos Types:</b> <b>Other Material:</b> Non-fibrous 100 %	119032154-24	No	NAD (by CVES) by Jean L. Mayes on 04/02/19

Client Name: WECL Inc

**PLM Bulk Asbestos Report**

Food Lion #1653; 1565 Hyde Park Station, Essex, MD

Client No. / HGA	Lab No.	Asbestos Present	Total % Asbestos
MM-25 Location: Deli; Ceiling Tile	119032154-25	No	NAD (by CVES) by Jean L. Mayes on 04/02/19
Analyst Description: White/Brown, Heterogeneous, Non-Fibrous, Bulk Material			
Asbestos Types:			
Other Material: Cellulose 10 %, Fibrous glass 5 %, Non-fibrous 85 %			
MM-26 Location: Deli; Ceiling Tile	119032154-26	No	NAD (by CVES) by Jean L. Mayes on 04/02/19
Analyst Description: White/Brown, Heterogeneous, Non-Fibrous, Bulk Material			
Asbestos Types:			
Other Material: Cellulose 10 %, Fibrous glass 5 %, Non-fibrous 85 %			

**Reporting Notes:**

Analyzed by: Jean L. Mayes

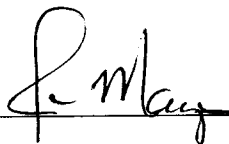

Date: 4/2/2019 Reviewed by:



\*NAD = no asbestos detected, Detection Limit <1%, Reporting Limits: CVES = 1%, 400 Pt Ct = 0.25%, 1000 Pt Ct = 0.1%; "Present" or NVA = "No Visible Asbestos" are observations made during a qualitative analysis; NA = not analyzed; NA/PS = not analyzed / positive stop; PLM Bulk Asbestos Analysis by EPA 600/R-93/116 per 40 CFR 763 (NVLAP Lab Code 101904-0) and ELAP PLM Analysis Protocol 198.1 for New York friable samples which includes quantitation of any vermiculite observed (198.6 for NOB samples) or EPA 400 pt ct by EPA 600/M4-82-020 (NYSDOH ELAP Lab # 10984); CA ELAP Lab # 2508; Note: PLM is not consistently reliable in detecting asbestos in floor coverings and similar NOB materials. NAD or Trace results by PLM are inconclusive, TEM is currently the only method that can be used to determine if this material can be considered or treated as non-asbestos-containing in New York State (also see EPA Advisory for floor tile, FR 59, 146, 38970, 8/1/94). NIST Accreditation requirements mandate that this report must not be reproduced except in full without the approval of the laboratory. This PLM report relates ONLY to the items tested.

Relinquished By: Andrew Cook Date/Time: 3/26/19  
 Received By: Date/Time:  
 Relinquished By: Date/Time:  
 Received By: Date/Time:

AMERISCI

WWW.AMERISCI.COM

119032154  
 BULK CHAIN OF CUSTODY  
 AMERISCI RICHMOND  
 13635 GENITO ROAD  
 MIDLOTHIAN, VA 23112  
 TOLL FREE: (800) 476-5227  
 PHONE: (804) 763-1200  
 FAX: (804) 763-1800

Company: Winchester Environmental Consultants, Inc

Street Address: PO Box 920

City: Verona State: VA Zip: 24482

Phone: 540-877-9420 Cell: 540-533-7532

Fax Results? Y ☐ Fax #:

Email Results? Y ☒ Email: acook@thinkweci.com

Results to: Andrew Cook; WECL, Inc

Special Instructions or Comments:

Project: Food Lion # 1653

AMERISCI #:

Proj Mgr:

Proj #:

Proj Address: 1565 Hyde Park Station Essex Proj State: MD

Analysis: ☒ PLM; ☐ Positive Stop; ☐ TEM; ☐ NY ELAP PLM/TEM w/ NOB Prep.

ASTM Dust ☐ (Microvac) ☐ (Wipe); ☐ Qualitative; ☐ Other (describe in comments)

Turnaround Time: 5 Day Material Type: ☒ Bulk ☐ Dust ☐ Water

Sampled By: Andrew Cook

Date Sampled: 3/26/19

Lab ID	Field ID	Location	Sample Description (dust area)	Homogenous Area
	M-1	Roof	White Caulk	1
	M-2		Black Caulk	2
	M-3	Throughout	Drywall / Siding	3
	M-4	"	"	3
	M-5	"	Ceiling tile	4
	M-6	"	"	4
	M-7	"	Black Base Coat	5
	M-8	"	"	5
	M-9	"	White 12x12 Floor tile	6
	M-10	"	" / Mastic	6
	M-11	"	Tan 12x12 Floor tile	7
	M-12	"	"	7
	M-13	Meat Area + In front of Deli	Orange 12x12 floor tile	8
	M-14	"	"	8
	M-15	"	Maroon 12x12 floor tile	9
	M-16	"	"	9
	M-17	Produce Area	Dark Gray 12x12 floor tile	10

RECEIVED

MAR 28 2019

By: [Signature]

PAGE 2 OF 2





**Asbestos License**

Andrew Cook  
Name

Signature

Inspector Review  
Course Title

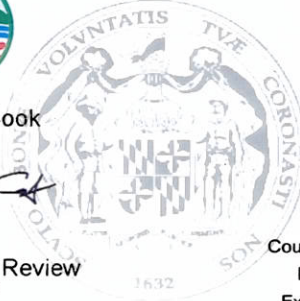

Course Date: 08/27/2018

Exp Date: 08/27/2019

Exam Date: 02/28/2019

**19004771**

**STATE OF MARYLAND**

# AEROSOL MONITORING & ANALYSIS, INC.

*This is to certify that*

**ANDREW COOK**

*has met the attendance requirements and successfully completed*

*the course entitled*

## 4-HOUR EPA ASBESTOS INSPECTOR REFRESHER

*For Accreditation Under TSCA Title II*

08/27/2018

Course Date

08/27/2018

Exam Date

8/27/2019

Expiration Date

STEVE SIERACKI

Principal Instructor

*Ann J. Stachurski*

AIR08272018-3

Certification No.

VAAIR08272018-3

Virginia Certification No.

E. Rush Barnett

Course Director

*E. Rush Barnett*

1331 Ashton Road

P.O.Box 646

Hanover, MD 21076

P: 410-684-3327

F: 410-684-3724

[www.amatraining.com](http://www.amatraining.com)